

PSW654-11EMKSD WINCH

PIERCE

PULLING FOR YOU

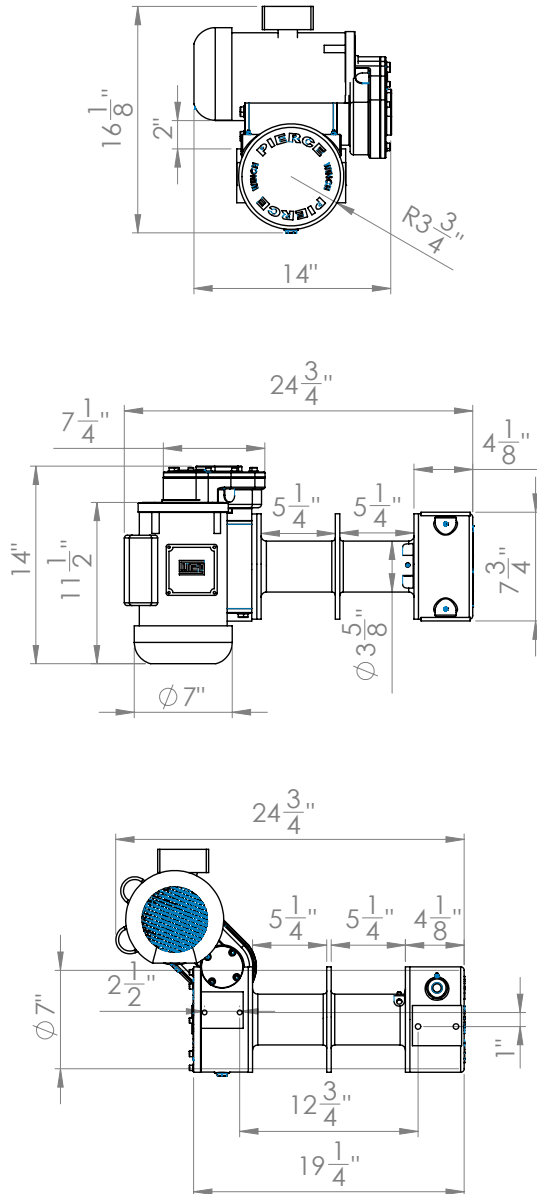
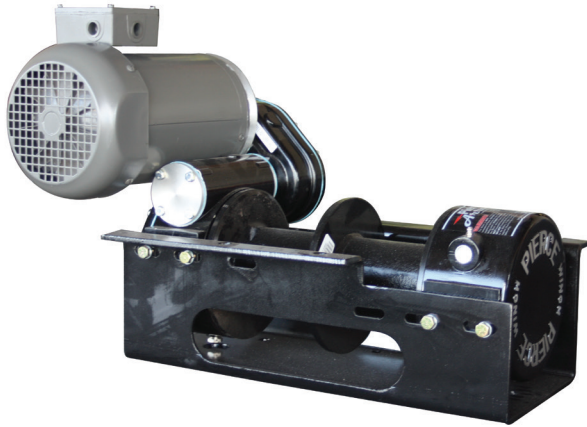

CATEGORY WINCH

PART NO. PSW654-11EMKSD

PRODUCT DESCRIPTION

11,000 lb Worm Gear Electric AC Winch / split drum

SPECIFICATIONS

RATED LINE PULL	11,000 lb
LINE SPEED	4 fpm
VOLTAGE	110V / 220V
RATIO	460:1
AMPERE	17.4 amps @ 115V
MINIMUM WIRE GAUGE	16 gauge
MOTOR	1.5 hp
WINCH CONSTRUCTION	Cast Metal
GEAR TRAIN	Worm Gear Ring Gear
CLUTCH	Dog
BRAKE	Worm Gear
ROTATION OF WINCH	CCW
DRUM SIZE	3.5" x 11" split
MOUNTING PATTERN	Pre-mounted
WIRE ROPE RECOMMENDED	3/8" x 50' (2)
WINCH WEIGHT	130 lb
GROSS WEIGHT	170 lb
WINCH DIMENSIONS (LxWxH)	26" x 15" x 17.5" (pre-mounted)
BOX DIMENSIONS (LxWxH)	Palletted