

## **AHBR I HAY BALE UNROLLER**

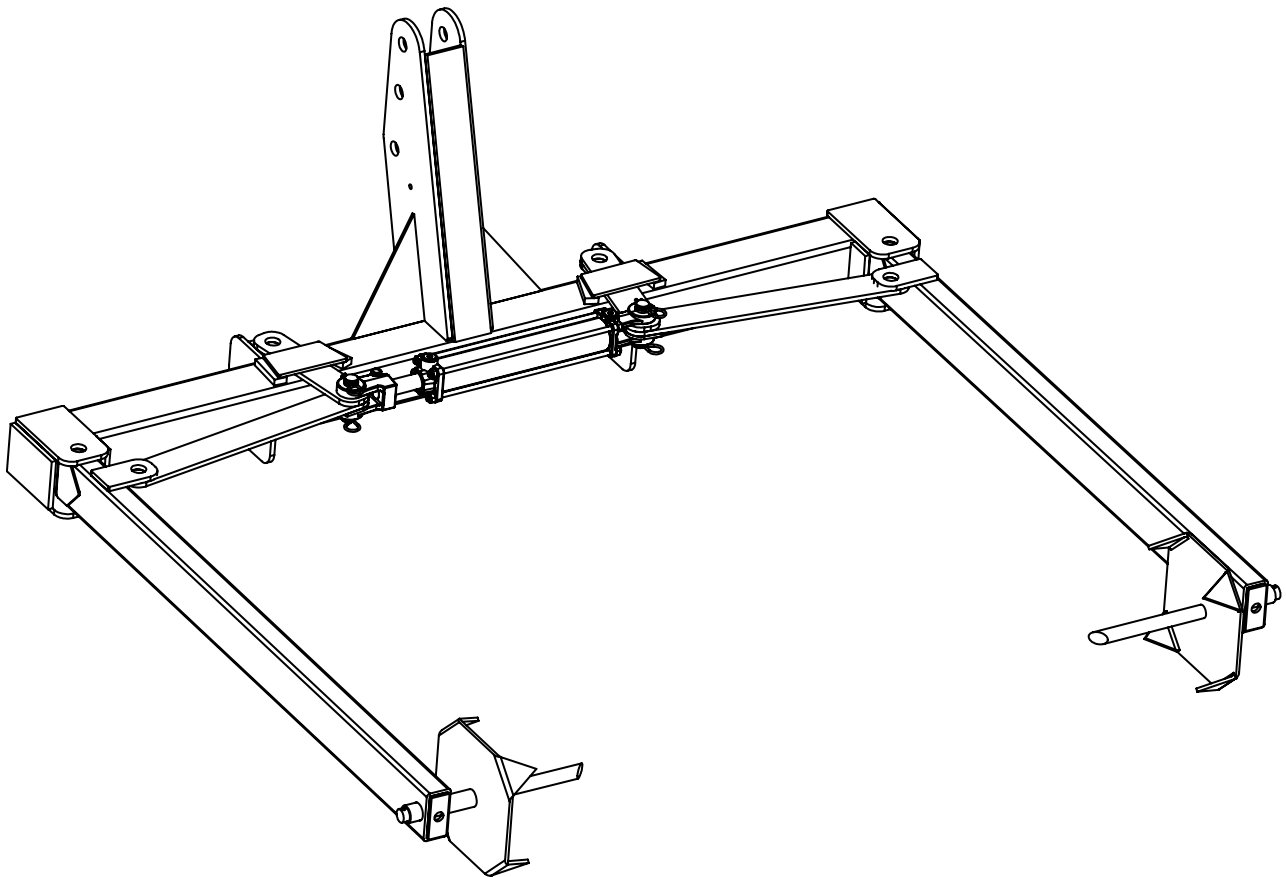

LM-03-00-0002 v2.0



549 US Highway 287 South, Henrietta, Texas 76365



Monday - Friday 8am to 5pm CST



+1-800-658-6301

**CALL PIERCE FOR ALL WARRANTY OR PRODUCT ISSUES!**

### **REGISTER YOUR PRODUCT TODAY!**

In order for us to best serve you, register your product by going to  
<https://www.piercearrowinc.com/warranty/product-registration/>  
Or scan the QR code to go directly there.



## MAINTENANCE

- Check all hoses for cracks and/or leaks. Make sure all pivot points are greased properly.
- Inspect the unit for any damages which may have occurred by repeated use in the field.
- Make sure all pins, bolts, nuts and screws are secure and proper for use.

## SAFETY WARNINGS

- Equipment may only be operated by those who are authorized, trained and responsible and in the cab of the tractor. Operators must know how to operate both the tractor and the hay bale unroller. Tractors with roll-over protective structures should be used.
- Use tools authorized by the manufacturer when assembling, installing, maintaining equipment.
- Two people may be required when handling heavy equipment. Do not strain when picking up equipment. Personal injury may result.
- Do not allow extra riders in the cab of the tractor during operation.
- Always wear your seat belt when operating the tractor.
- Drive slowly when moving a hay bale.
- Do not lift hay bales larger than 6' high.
- Do not drive or operate near water, ditches or creeks.
- Obey all highway laws for farm machinery.
- Do not drive on public roads without proper reflectors and warning lights.
- Be alert and drive conservatively. Drive slowly around corners.
- Counter weights may need to be installed to your tractor. Do not exceed the limits of your machinery. Check the tractor's weight limit before operation.
- Before removing the hay bale unroller from the tractor, be sure to turn off the tractor and lock the brakes.
- Stay clear of the tractor and hay bale unroller while the tractor is backing up.
- Stay clear of low electrical or power lines while driving.
- Do not remove the hay bale unroller around children.
- Do not wear loose fitting clothing during installation and operation.
- Modifying the equipment may result in personal injury and / or voided warranty.

## SPEC INFORMATION

**Spec information including lifting capacity can be found on page 10**

## PARTS

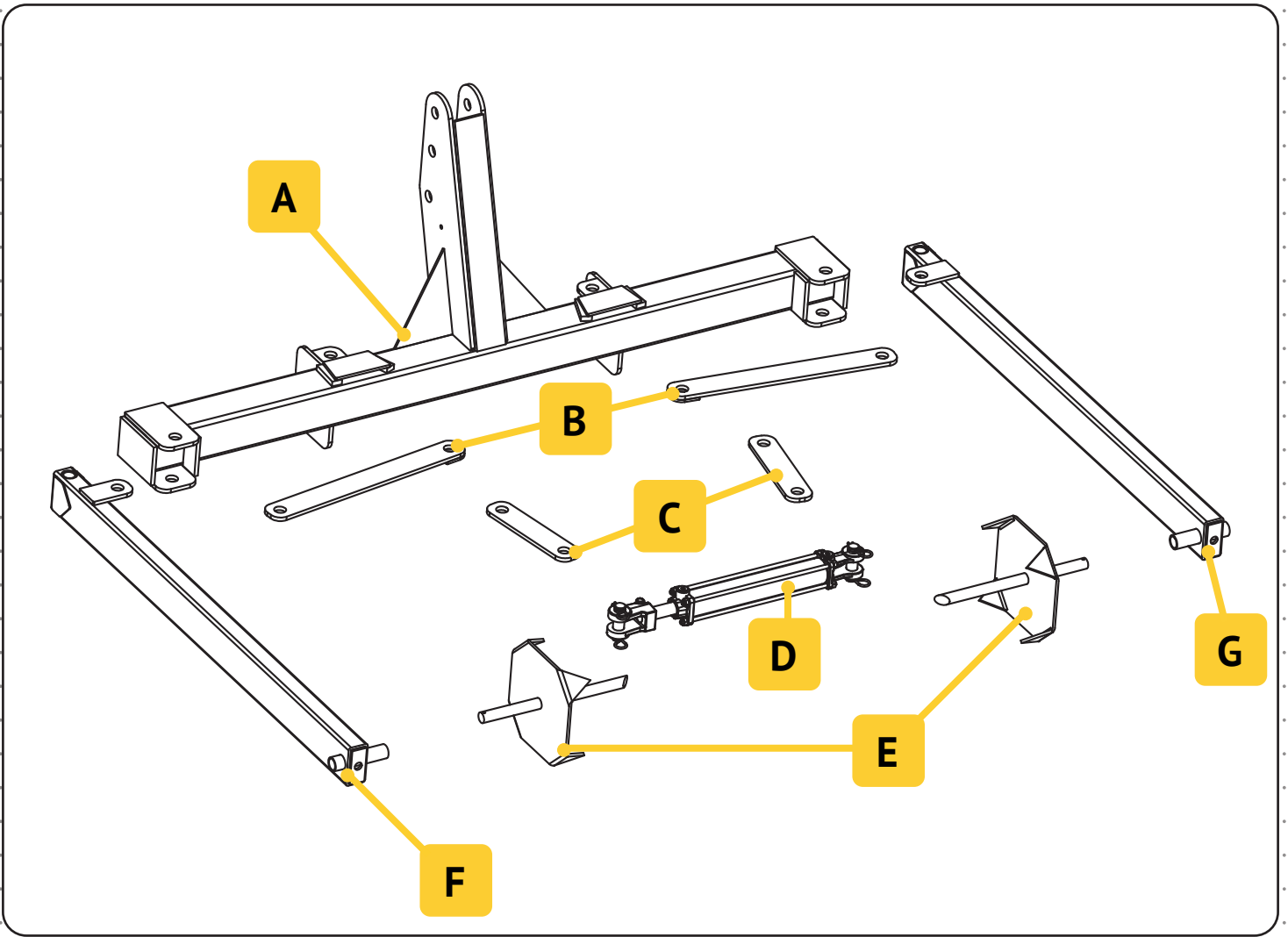

## PARTS

**A**

**AHBR1SQBARV3**

Hay bāle unrōller bāse

**B**

**AHBR1ARMGUIDE**

Arm guides

**C**

**AHBR1-CGP**

Cylinder guides

**D**

**P0532X12-6**

Cylinder

**E**

**AHBR1SQPLATE**

Squeeze plate

**F**

**AHBR1LARM**

Driver side arm

**G**

**AHBR1RARM**

Passenger side arm

# ASSEMBLY

1

## COMPONENTS:

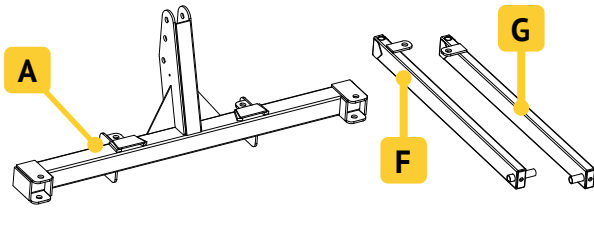

**A** AHBR1SQBARV3

Hay bale unroller base

**F** AHBR1LARM

Driver side arm

**G** AHBR1RARM

Passenger side arm

## DIRECTIONS:

Using two 1.5" wrenches, tightly bolt the driver and passenger arms (F & G) to the hinge on the base (A) with the provided 1" x 6" G8 bolts and 1" top lock nut.

**NOTE:** The silver top locks do not have the nylon insert and are shorter. These **MUST** be used on the arms.

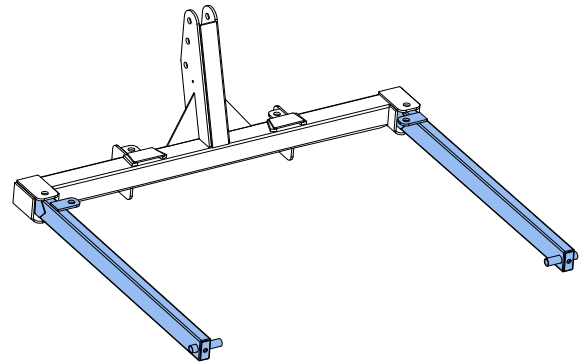
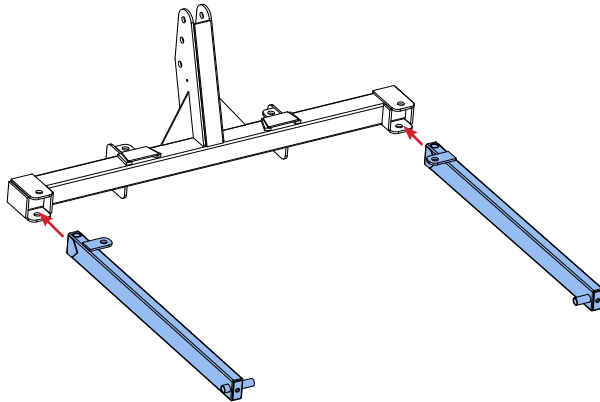

2

## COMPONENTS:

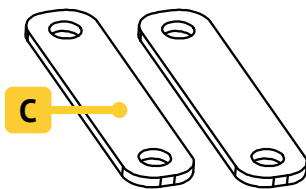

**C** AHBR1-CGP

Cylinder guides

## DIRECTIONS:

Using two 1.5" wrenches, secure the guides (C) to the base using the supplied 1" flat washer, 1" x 2.5" G8 bolt and 1" lock nut. These are the shorter guides.

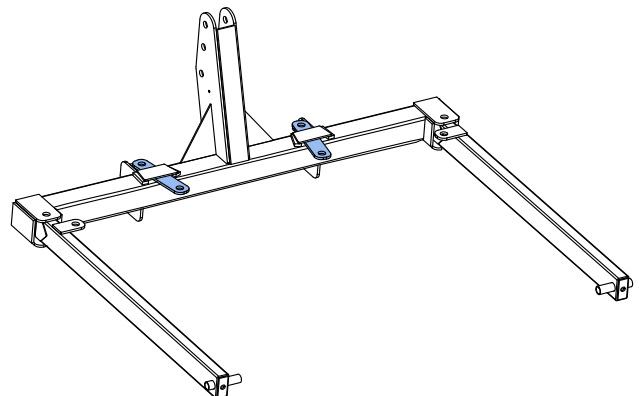
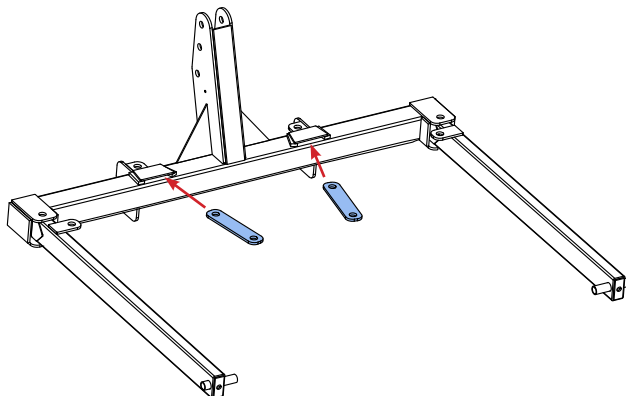

## ASSEMBLY

3

### COMPONENTS:

**B**

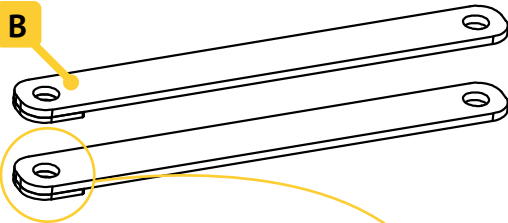

**B** AHBR1ARMGUIDE

Arm guides

### DIRECTIONS:

Using two 1.5" wrenches, secure the arm guides (B) to the arms using the supplied 1" x 6" G8 bolts with grease zerks. The guides should be loose enough to allow the arms to move while remaining secure. See note below for proper orientation.

**NOTE:** The thicker side of the guide should be placed on the inside of the unit, facing towards the cylinder.

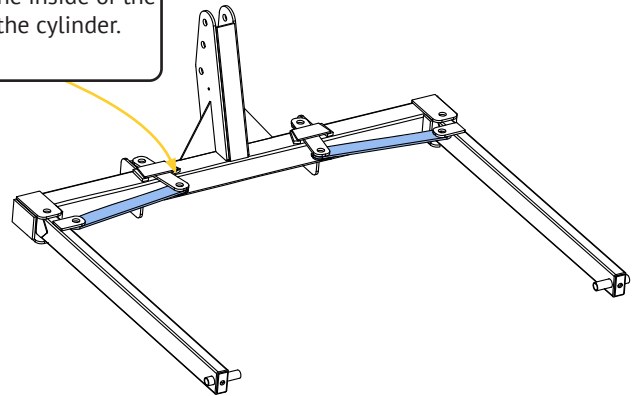
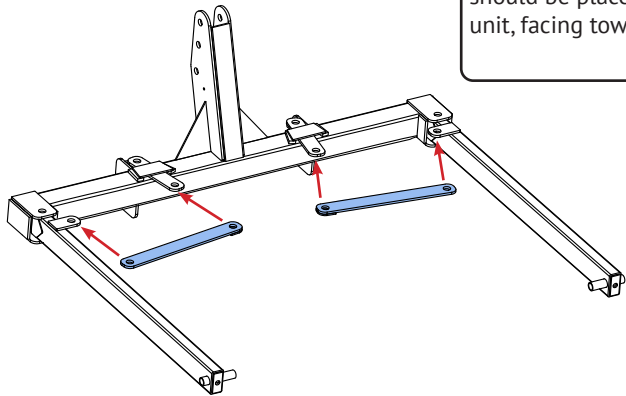

4

### COMPONENTS:

**D**

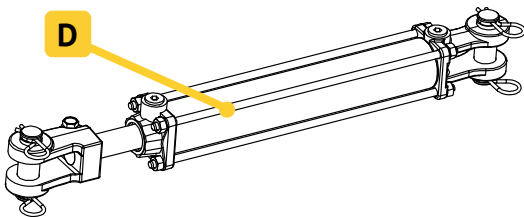

**D** P0532X12-6

Cylinder

### DIRECTIONS:

Pin the cylinder to the arm guides with the hydraulic ports facing upwards.

Cylinders may have a restrictor fitting (see page 8 for more detail)

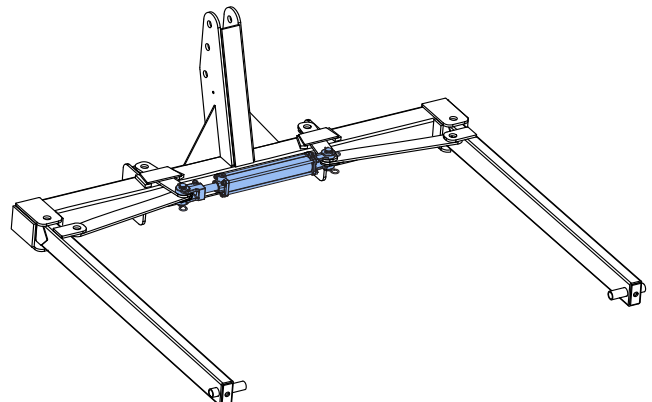
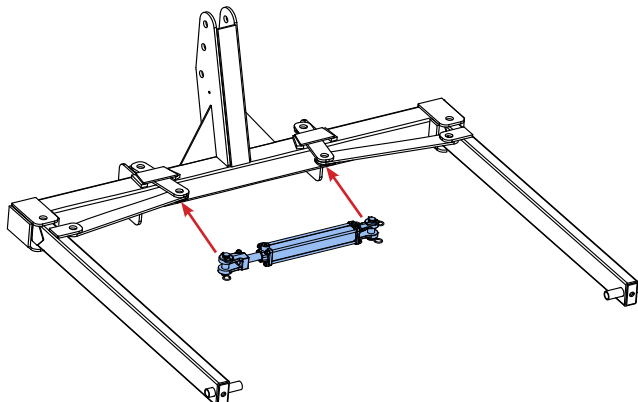

5

## COMPONENTS:

E

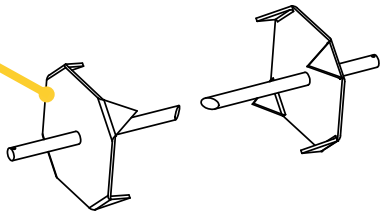

**E AHBR1SQPLATE**  
Squeeze plate

## DIRECTIONS:

Slide the squeeze plate (E) to the collar-end of the arm (F & G see page 4 step 1). Secure using the supplied 1/4" lynchpin.

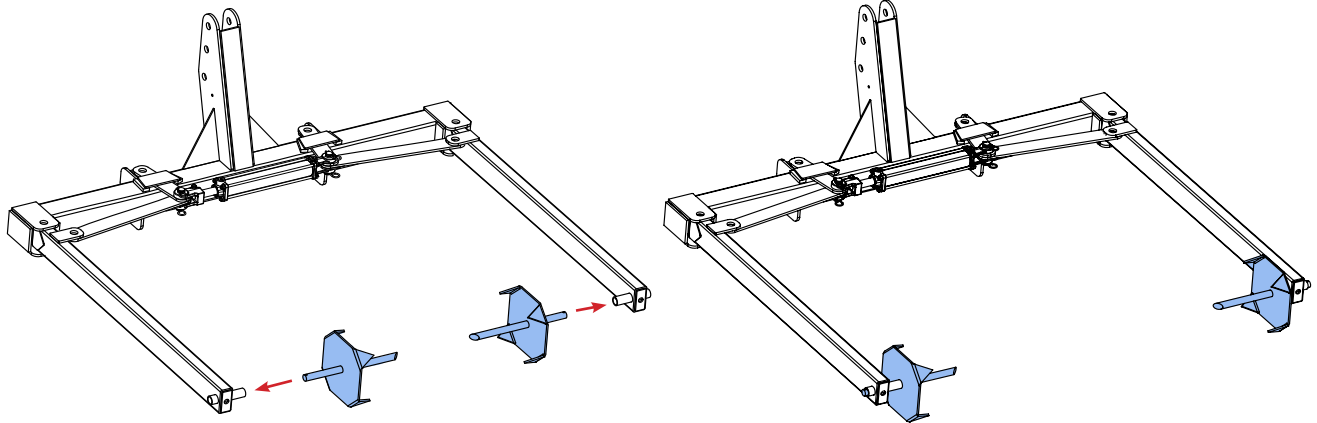

## 4 FT. EXTENSION UNIT

### DIRECTIONS:

A special attachment is needed for use with 4 ft. bale.  
Please note this is an **optional** component and **does not** come with the standard kit.

Using this component **REDUCES THE LIFTING CAPACITY** from 2,500 lbs. to 1,000 lbs.

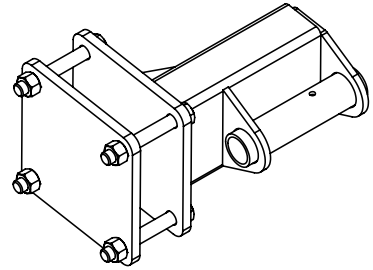

4E

### COMPONENTS:

4E

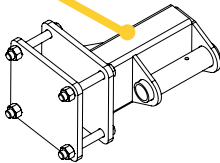

E

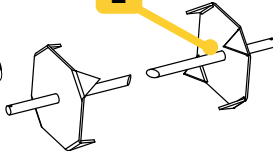

4E AHBR14E

4 Ft. Bale extension add on

E AHBR1SQPLATE

Squeeze plate

### DIRECTIONS:

Bolt the extension to both arms as close to the collar end of the arms as possible.

Then attach and secure squeeze plate to the extension using the keeper pin

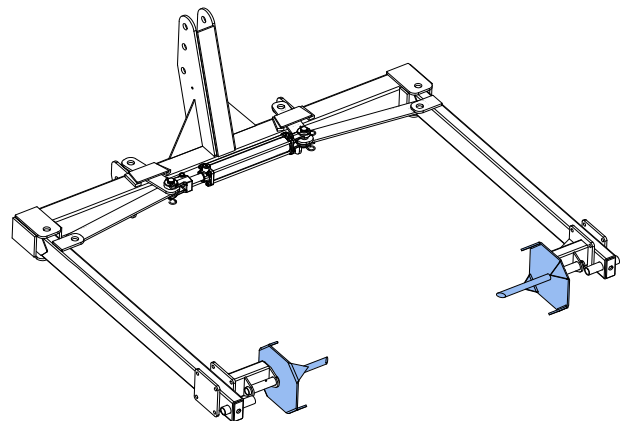
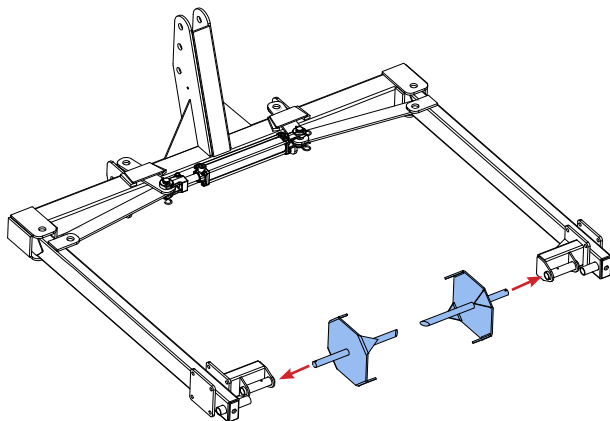
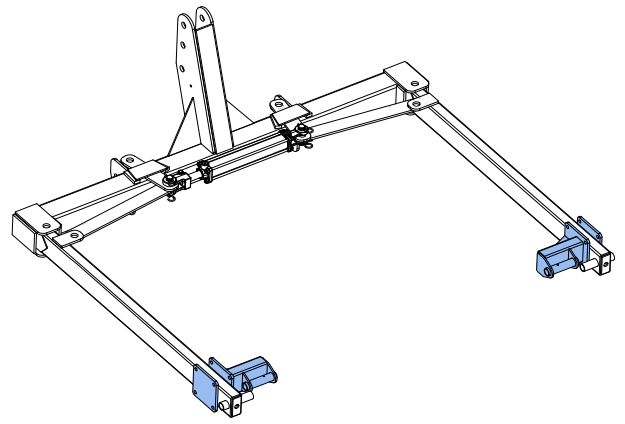
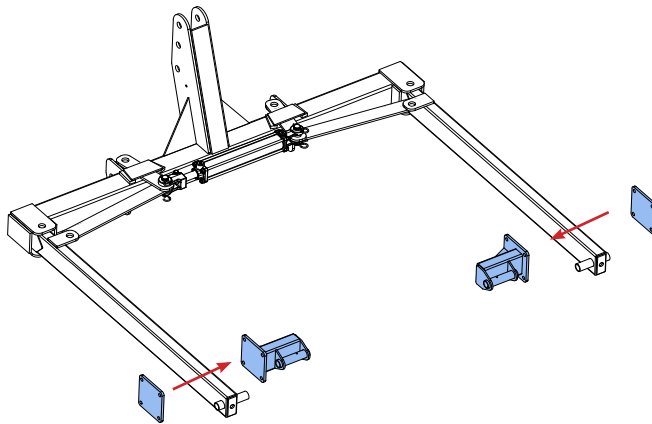

## ASSEMBLY

### INSTALLATION

Two people will need to lift the hay bale unroller. Attach the hay bale unroller frame to the tractor's left bottom link using the (1) pre-installed lift arm pin and (1) 7/16" keeper pin. Repeat on the right side. **(figure 1 and 2)**

Attach the hay unroller frame to the tractor's top lift link using a 7/8" hitch pin (not supplied). **(figure 3)**

\*\* For Cat II tractors use the included bushings to remove slack between the tractor's lifting arm and the unroller's square bar.

### GREASE

*Grease the following four grease points using a grease gun and red bearing grease:*

1. Driver side squeeze bar bolt (AHBR1SQBAR) (1" x 6" G8 bolts with grease zerk) **(figure 4)**
2. Passenger side squeeze bar bolt (AHBR1SQBAR) (1" x 6" G8 bolts with grease zerk) **(figure 5)**
3. Within the collar-end of the driver side arm (AHBR1LARM). **(figure 6)**
4. Within the collar-end of the driver side arm (AHBR1RARM). **(figure 7)**

### HYDRAULICS

Connect to the tractor's 3 point hook up using the provided quick connect hoses. Connect the male end of the hydraulic hose into the 1/2" female breakaway coupler on your tractor.

Your Hay Bale Unroller is assembled with a restrictor fitting to slow the flow that some larger tractors produce for smoother operating. If your hay bale unroller is too slow, remove the fitting **(figure 8)**

### OPERATION

- Once the bale unroller arms are in position, ensure the tractor is in line with the bale. Back up until the spike grips are near the center of the bale. Only grip the center of the bale. Using the tractors control system, close the arms until the bale is gripped securely. Raise the bale high enough to move the bale to it's destination – approximately 10".
- Once the bale is in position to be unrolled, remove all netting around the bale.
- To unroll the hay, lower the arms and drive forward. The bale will roll and dispense even layers of hay.



# ASSEMBLY

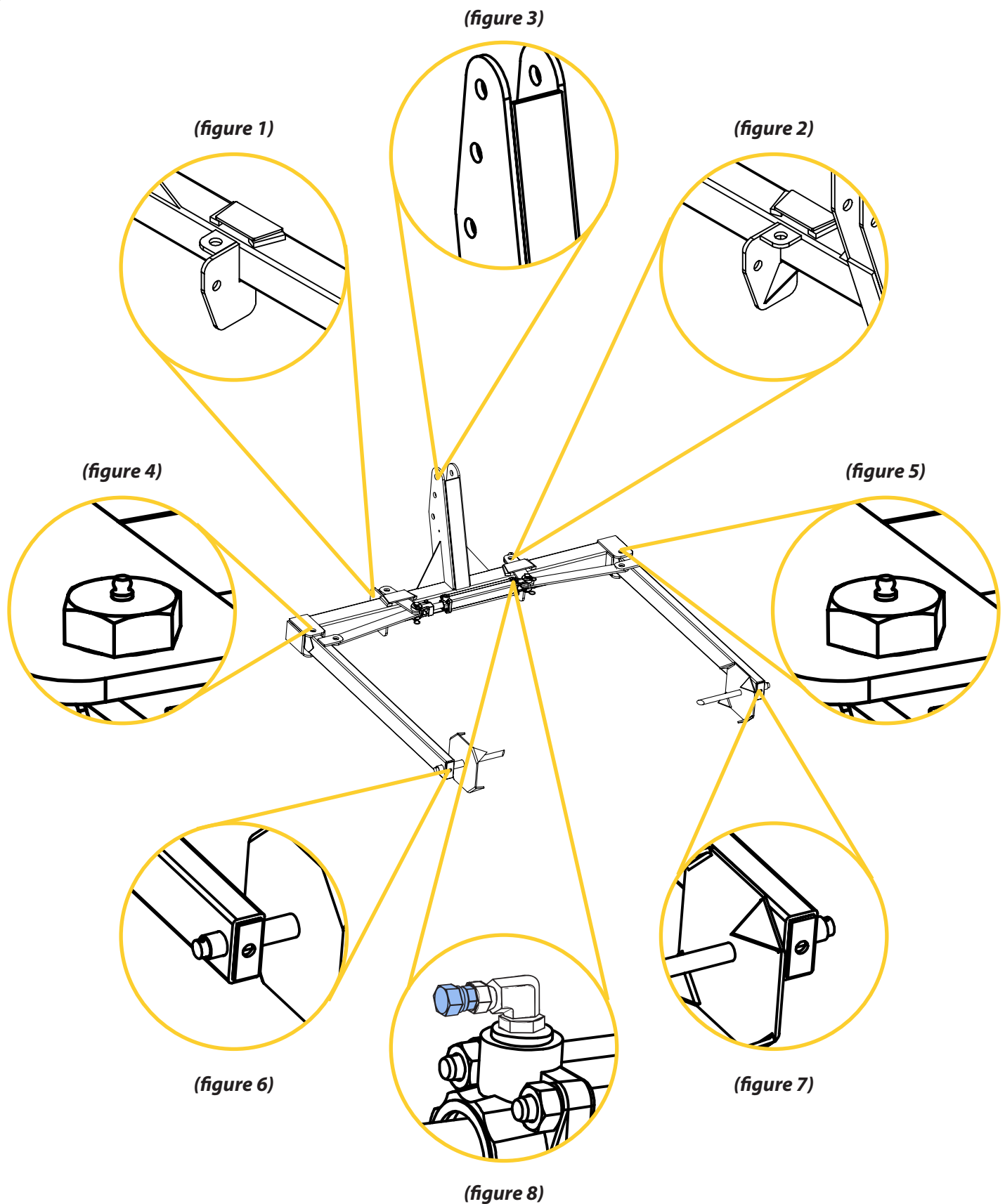

## HAY BALE UNROLLER

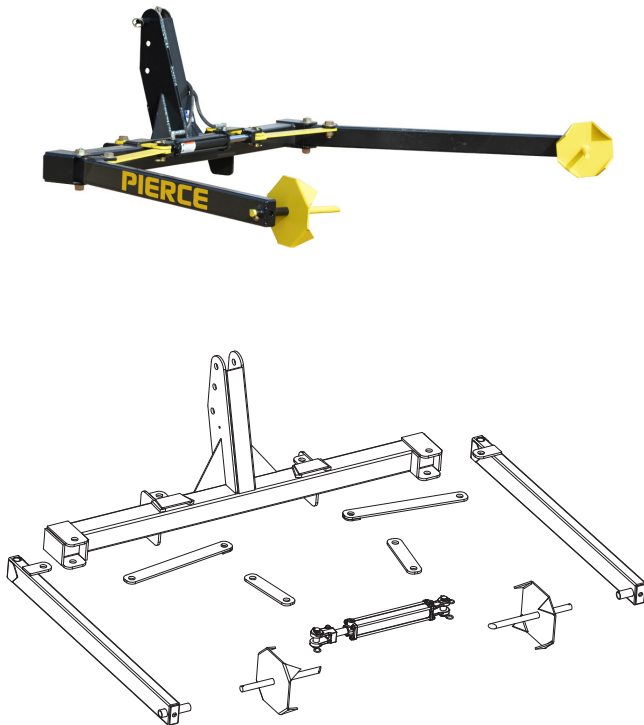

**PIERCE**<sup>®</sup>  
PULLING FOR YOU

**CATEGORY** FARM & RANCH

**PART NO.** AHBR1

### PRODUCT DESCRIPTION

Hay Bale Unroller / Three Point Attachment

### SPECIFICATIONS

<b>CAPACITY</b>	2,500 lbs.
	1,000 lbs with 4 ft. extension
<b>HITCH TYPE</b>	Category 1 or 2
<b>BALE HANDLING</b>	5' or 6' Large Round
	1 Bale at a time
<b>SET UP TIME</b>	5 mins.
<b>CYLINDER</b>	2" x 12" tie rod
<b>PSI</b>	3,000 psi
<b>WARRANTY</b>	2 years
<b>PRODUCT WEIGHT</b>	270 lbs.
<b>GROSS WEIGHT</b>	≈ 350 lbs.
<b>DIMENSIONS</b>	72.75" x 52" x 30"
<b>ORIGIN</b>	Made in Texas

Pierce Arrow Inc. • 549 U.S. HWY 287 S. • Henrietta, Texas 76365 • 1-800-658-6301 • [www.piercearrowinc.com](http://www.piercearrowinc.com)

LSS-03-00-0001 v2.0

## LIMITED WARRANTY

Pierce Arrow Inc. warrants that the goods, equipment, and merchandise manufactured by Pierce Arrow Inc. are free from defects in material and workmanship. The limited warranty includes replacement or repair of defective mechanical and electrical parts for a period of two years from the date of shipment by Pierce Arrow Inc.

### OBTAINING WARRANTY SERVICE

Pierce Arrow Inc. must be notified of any defect before repair or replacement may be granted. The merchandise must be delivered by the purchaser to Pierce Arrow Inc. in Henrietta, Texas at the purchaser's expense. Any repairs not made by Pierce Arrow Inc. are not covered by the limited warranty and are the responsibility of the purchaser.

Pierce Arrow Inc. Reserves the right to repair or replace defective parts or products in its sole discretion. The cost of any repairs not covered by the warranty will be charged to the purchaser.

### EXCLUSIONS

All PIERCE products are manufactured for a specific intended purpose. The Pierce Arrow Inc. limited warranty does not cover, and Pierce Arrow Inc. is not liable for, damage arising from any use other than the specific intended use of each product.

The Pierce Arrow Inc. limited warranty does not cover:

- Ongoing maintenance parts or repair due to normal wear and tear.
- Any change or defect due to accident, misuse or any use for which the equipment was not intended, improper or unauthorized repair, failure to provide regular maintenance, and deterioration due to weather or road conditions.

Purchasers should consult their owner's manual for safety, installation, operation, and maintenance guidelines.

The Pierce Arrow Inc. limited warranty does not cover purchaser's cost of labor, transportation, shipping damages, installation or removal costs, down time, loss of profit or goodwill, or any other special incidental, indirect, or consequential damages, concerning or related to any product or part, whether based upon negligence, strict liability, breach of contract, breach of warranty, misrepresentation, or any other legal theory.

Merchandise manufactured by Pierce Arrow Inc. is not designed or intended for the movement of people and are not to be used in the operation of elevators or other improper uses. Any improper use of the product will void the warranty.

### OTHER MANUFACTURERS' WARRANTIES

Pierce Arrow Inc. makes no warranty, expressed or implied, to finished products manufactured or supplied by other manufacturers, and sold by Pierce Arrow Inc. to the purchaser, including but not limited to, any vehicle to which our product is affixed and any accessories. Such merchandise is subject to the manufacturer's warranty only, which will be provided upon request.

### CONDITIONS OF SALE

When placing an order with Pierce Arrow Inc., the terms and conditions provided for payment, shipping, delivery and claims create an agreement between the purchaser and Pierce Arrow Inc. The agreement is to be performed in Clay County, Texas.

**RETURNS:** No returns are accepted without prior authorization. All items must be returned in their entirety. Please contact a sales representative for authorization. Upon authorization, returns must be shipped freight prepaid and may be subject to a 15% restocking fee. Please do not send returns COD. No returns will be accepted later than 30 days from the date of invoice.

**DAMAGED GOODS:** Pierce Arrow Inc. is not responsible for, and has no liability for:

- Damage arising during shipment
- Any change or defect due to accident, misuse or any use for which the equipment was not intended, improper or unauthorized repair, failure to provide regular maintenance, and deterioration due to weather or road conditions.

**CLAIMS:** Claims for breakage or damages during shipping must be made to the carrier at the time of delivery. If a signature is required, you must notify the driver and sign that there was damage. You must notify Pierce Arrow Inc. of the damage promptly so that a claim can be filed.

# PIERCE<sup>®</sup>

## PULLING FOR YOU

### *Thank you for choosing PIERCE!*

We strive for 100% customer satisfaction.

We are committed to excellent customer service because we are *pulling for you*.

#### LEARN MORE ABOUT PIERCE PRODUCTS

Call our team today with any further questions or inquiries you have about our products. Check out our resource library to access PIERCE specification sheets, wiring diagrams, and manuals. Follow the link below or scan the QR code.

<https://www.piercearrowinc.com/documents/>



#### KEEP IN CONTACT AND SHARE YOUR FEEDBACK

Do you see something missing? Are the directions still unclear? No worries our sales team and technical service reps are ready and here to help you. If you're 100% satisfied consider leaving us a review on Google at [www.piercearrowinc.com](https://www.piercearrowinc.com)



549 US Highway 287 South, Henrietta, Texas 76365



Monday - Friday 8 a.m. to 5 p.m. CST



[sales@piercearrowinc.com](mailto:sales@piercearrowinc.com)



[www.piercearrowinc.com](https://www.piercearrowinc.com)



+1-800-658-6301

#### SHIPPING INFORMATION

All orders placed over the weekend will ship the following Monday unless it's a holiday.

Orders placed during holidays will ship when we return for work.

### CALL PIERCE FOR ALL WARRANTY OR PRODUCT ISSUES!

#### REGISTER YOUR PRODUCT TODAY!

In order for us to best serve you, register your product by going to

<https://www.piercearrowinc.com/warranty/product-registration/>

Or scan the QR code to go directly there.

